

Norfolk (Type C)

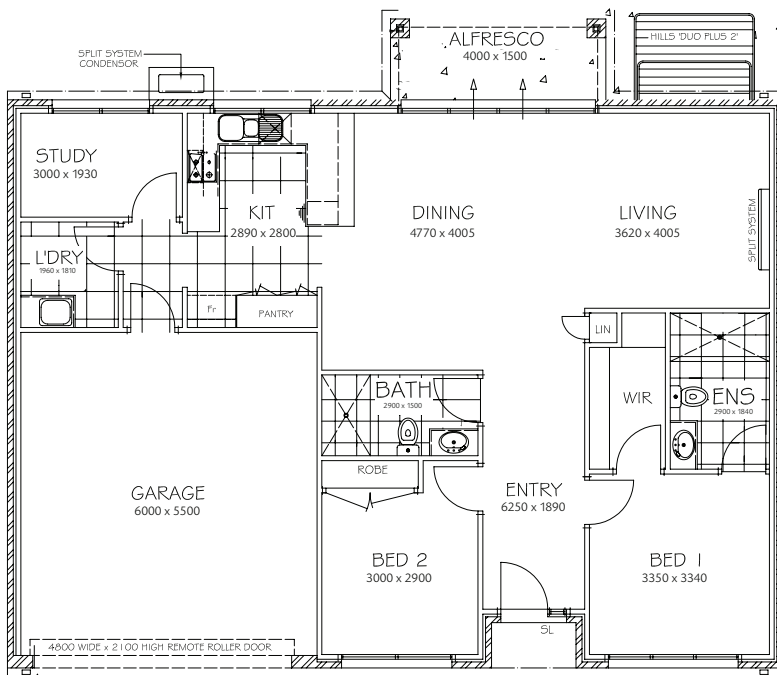

A spacious two-bedroom and study home, with generous and functional living/dining area. It has a double garage also for the second car or extended workshop or storage.

It enjoys enhanced outlooks from a greater portion of the home, whilst maintaining all the privacy that you would expect. If you require extra space for visitors, storage or hobbies, this is the home for you.

The home size (including garage) is 158 m2 approximately.

Anchor Point

All dimensions are approximate

 Endeavour
Over 55 Living

www.endeavourliving.com.au